

FOURTH IMPLEMENTATION PLAN
FOR THE
SOUTHCREST REDEVELOPMENT PLAN

For the Period
July 2009 – June 2014

Approved Pursuant to Agency Resolution No.:
Date of Final Passage:
Document No.:

Southeastern Economic Development Corporation
(SEDC)

TABLE OF CONTENTS

July 2009 – June 2014 Implementation Plan

Southcrest Redevelopment Project Area

i.	Map of Project Area	
ii.	Project Area Profile	
I.	Introduction	1
	A. Redevelopment Division	1
	B. Southeastern Economic Development Corporation (SEDC)	1
	C. Southcrest Project Area	2
II.	Description of Project Area Blighting Conditions.....	2
III.	Project Area Goals and Objectives	3
IV.	Goals and Objectives, Proposed Projects, and Contribution to Blight Alleviation for the Five Year Period.....	3
	A. Goals and Objectives.....	3
	B. Proposed Private Projects	4
	C. Proposed Public Improvements	5
	D. Proposed Expenditures	6
V.	Explanation of How the Goals and Objectives, Projects and Expenditures will Eliminate Blighting Conditions.....	7
VI.	Explanation of How the Goals and Objectives, Projects and Expenditures will Eliminate Implement Project Housing Requirements (Housing Compliance Plan).....	8
	A. Comprehensive Affordable Housing Strategy	8
	B. Housing Assistance Programs	9
	C. Projects and Expenditures to be Made During the Next Five Years	10
	1. Projected Housing Units to be Developed in the Next Five Years	10
	2. Agency-Developed Units.....	12

D. Housing Unit Estimates for the Next Ten Years and the Life of the Plan	14
E. Very Low, Low and Moderate Income Units Developed in the Project Area	14
TABLE A: Details of Housing Production	15
F. Replacement of Housing Units Destroyed or Removed	16
G. Compliance with Housing Element and Regional Housing Share Requirements	16
TABLE B: Housing Expenditures and Proportionality	19

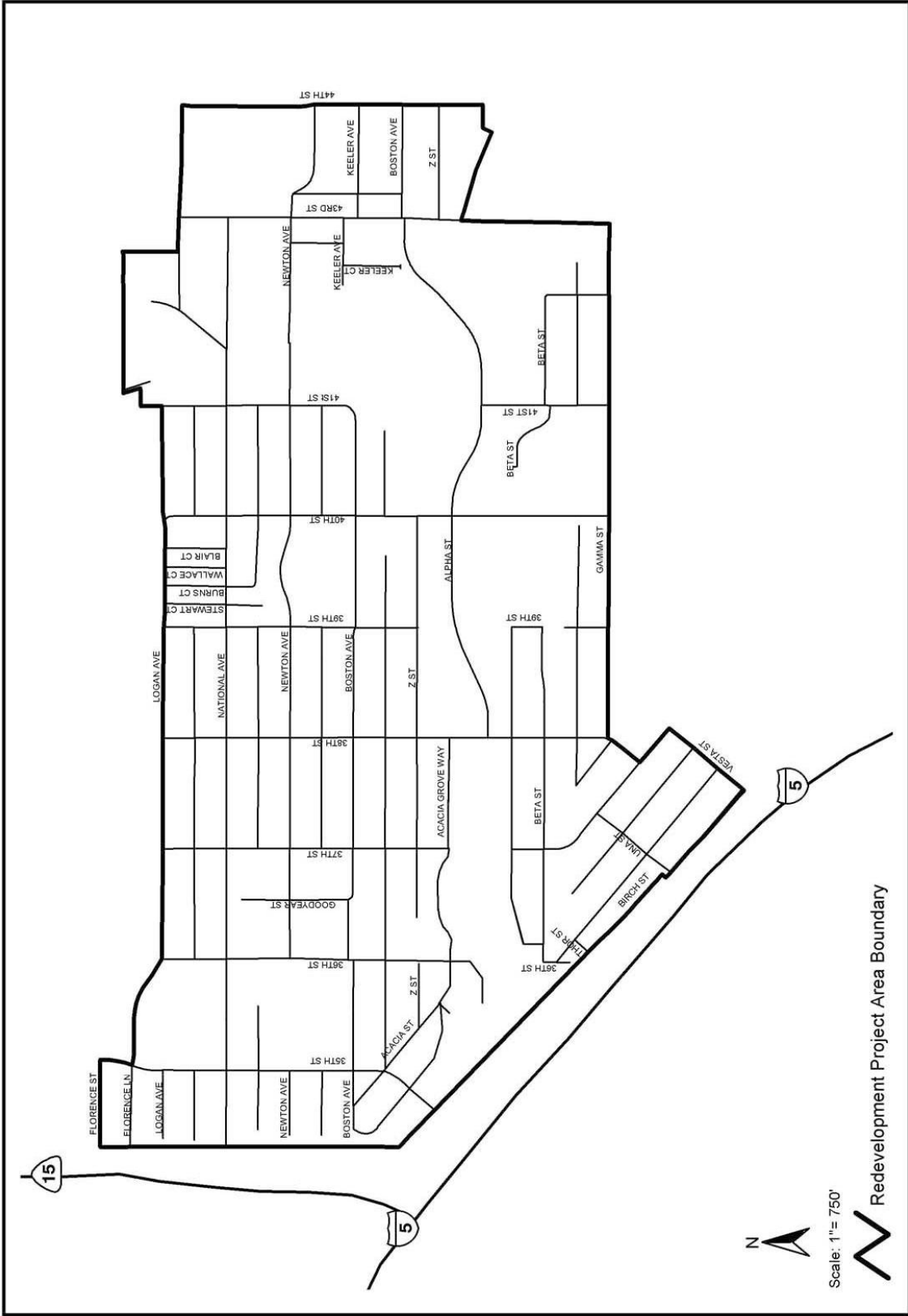

SOUTHCREST
Redevelopment Project Area



**Project Area Profile
Southcrest Project Area**

Land Area:	Approximately 301 net acres (excludes public rights-of-way)
Boundary:	East of State Route 15 and Interstate 5, south of Logan Avenue, west of 44th Street, and north of Gamma and Vesta Streets
Land Use:	75% Residential 9% Commercial 6% Park 5% Commercial/Business Park 5% Open Space
Date Adopted:	April 14, 1986
Date of Amedment:	First Amendment November 22, 2004
Time Limit for Effectiveness of Redevelopment Plan:	April 14, 2027
Time Limit for use of Eminent Domain:	N/A
Time Limit for Incurring Debt:	April 14, 2027
Time Limit for Repayment of Debt:	April 14, 2037
Tax Increment Limit:	\$87.0 million
Current Tax Increment:	\$2.4 million

I. INTRODUCTION

This document contains the five-year Implementation Plan for the period July 2009 – July 2014 for the Southcrest Redevelopment Project Area (Project Area), administered by the Southeastern Economic Development Corporation (SEDC) on behalf of the Redevelopment Agency of the City of San Diego (Agency). The Implementation Plan is being prepared and adopted in accordance with State Health and Safety Code Section 33490 and related sections. These sections outline the purpose and requirements of the Implementation Plan as follows:

- Agencies were required to adopt their first five-year Plan(s) for existing Project Areas by December 1994.
- Each Plan must state the Agency's goals and objectives for the Project Area, identify specific programs and expenditures over the next five years, and describe how these goals and objectives, programs, and expenditures will alleviate blight.
- Each Plan must identify approaches to increase, improve and preserve the supply of low and moderate income housing. The Plan must further incorporate a plan to meet mandated housing production, affordability, and targeted income requirements.
- Each Plan may be adopted only after a noticed public hearing has been conducted. The adoption of the Plan does not constitute a "Project" within the meaning of the California Environmental Quality Act.

A. Redevelopment Division

The Redevelopment Agency of the City of San Diego was established by the City Council in 1958. The City Council is the Board of Directors of the Agency. Project implementation and administration for the Agency are provided by three separate and distinct organizations: Centre City Development Corporation, Southeastern Economic Development Corporation and the Redevelopment Division of the City's City Planning & Community Investment Department. The Redevelopment Division performs general administration for the Redevelopment Agency, coordinates budget and reporting requirements, and maintains the Agency's meeting docket and official records. The Division also administers eleven project areas which includes College Community, Barrio Logan, City Heights, College Grove, Crossroads, Grantville, Linda Vista, Naval Training Center, North Bay, North Park and San Ysidro.

B. Southeastern Economic Development Corporation

SEDC was created in 1981 by the City of San Diego to manage all redevelopment and economic development activities within the southeastern San Diego community. SEDC is a non-profit public benefit corporation providing redevelopment planning, management, and implementation services to the southeastern San Diego community which encompasses an approximately seven-square-mile area east of downtown San Diego. The community generally consists of 15 neighborhoods within four (4) adopted redevelopment project areas – Central Imperial, Gateway West, Mount Hope and Southcrest, and also includes a study area known as the Dells Imperial Study Area.

C. Southcrest Project Area

The Southcrest Project Area was adopted on April 14, 1986 by Ordinance No. 16622. The Project Area Profile reflects multiple ordinances that have been adopted to amend portions of the Redevelopment Plan. The most recent Ordinance is No. O-19682, passed by the City Council on November 20, 2007. The Project Area encompasses approximately 301 acres located east of State Route 15 and Interstate 5, south of Logan Avenue, west of 44th Street, and north of Gamma and Vesta Streets.

II. DESCRIPTION OF PROJECT AREA BLIGHTING CONDITIONS

The Project Area has long suffered from a loss of private investment and development activity, due in large part to deteriorating physical and economic conditions. The Agency's Report to the City Council presented detailed assessments of blighting conditions in the Project Area, including both physical deterioration and economic dislocation. The following blighting influences were identified:

- Negative impacts of the abandoned, 66-acre Highway 252 corridor, including illegal activities, property deterioration, and loss of small business activity.
- High crime rate/lack of public safety.
- High vacancies, in commercial structures.
- A large percentage of deteriorated and dilapidated structures.
- Inadequate public improvements, facilities, and utilities.
- Inferior traffic circulation.
- Lack of adequate shopping facilities.

- Business migration out of the Project Area.
- High unemployment rate.
- Lack of affordable housing options.
- Irregular and substandard parcel size and shape.

III. PROJECT AREA GOALS AND OBJECTIVES

The Redevelopment Plan identified the following key objectives and actions for revitalization of the Project Area:

- Promote revitalization of the Southcrest community.
- Provide incentives for development of new commercial facilities to better serve the community.
- Provide incentives for development of under-utilized parcels.
- Develop the rescinded Highway 252 corridor with new housing and commercial and industrial businesses.
- Maintain the existing residential character along National Avenue.
- Ensure maximum business and employment opportunities for local residents.
- Provide better lighting, streetscape, traffic, and other public improvements.
- Encourage community involvement.

IV. GOALS AND OBJECTIVES, PROPOSED PROJECTS, AND CONTRIBUTION TO BLIGHT ALLEVIATION FOR THE FIVE-YEAR PERIOD

A. Goals and Objectives

As described in the Southcrest Redevelopment Plan, April 1986, the Project Area was chosen for redevelopment in order to eliminate blighting influences, strengthen residential areas and

provide new housing opportunities, strengthen existing businesses, and attract commercial, industrial and retail businesses.

B. Proposed Private Projects

The following table describes proposed private projects and programs and their contribution to blight removal:

Project	Project Description	Contribution to Blight Removal
40th and Alpha Residential Development	Potential for construction of a minimum of six (6) for-sale homes	<ul style="list-style-type: none"> • Utilizes unproductive land • Increases supply of affordable housing • Provide homeownership opportunities • Provides stability to the Project Area by enhancing the permanent residential base
Miscellaneous Multi-Family Development Opportunities	Assess potential of working with existing multi-family residential property owners on a case-by-case basis regarding rehabilitation and/or redevelopment opportunities	<ul style="list-style-type: none"> • Preserves supply of affordable housing • Provides stability to the Project Area by enhancing the permanent residential base • Alleviates crime/lack of public safety • Alleviates depreciated/stagnant property values
Miscellaneous Single-Family Development Opportunities	Assess potential of working with existing single-family residential property owners on a case-by-case basis regarding rehabilitation and/or redevelopment opportunities	<ul style="list-style-type: none"> • Preserves supply of affordable housing • Preserves homeownership • Provides stability to the Project Area by enhancing the permanent residential base • Alleviates crime/lack of public safety • Alleviates depreciated/stagnant property values
Rehabilitation of Mayberry Townhomes	Minor rehabilitation of 69 very low and low income rental townhomes; site is partially located in Project Area	<ul style="list-style-type: none"> • Preserves supply of affordable housing • Provides stability to the Project Area by enhancing the permanent residential base
Various Site Acquisitions	Identify funding and coordinate with property owners to develop vacant or underutilized sites	<ul style="list-style-type: none"> • Utilizes unproductive land • Preserves supply of affordable housing • Provides stability to the Project Area by enhancing the permanent residential base • Serves unmet residential and commercial needs • Alleviates crime/lack of public safety • Creates neighborhood stability • Alleviates depreciated/stagnant property values • Creates employment opportunities

Various Mixed-Use Development Projects	Assess potential of working with existing property owners on a case-by-case basis regarding rezones and/or development of underutilized properties within the Project Area	<ul style="list-style-type: none"> • Utilizes unproductive land • Increases potential for: <ul style="list-style-type: none"> ○ affordable housing ○ homeownership opportunities ○ commercial and retail needs ○ employment opportunities • Alleviates crime/lack of public safety • Alleviates depreciated/stagnant property values
--	--	---

C. Proposed Public Improvements and Programs

The following table describes proposed public improvement projects and programs and their contribution to blight removal:

Project	Project Description	Contribution to Blight Removal
252 Corridor Park Alley Improvements	Installation of public improvements in the alley along the south side of the 252 Corridor Park (Phase II); improvements will be designed in conjunction with the Park Improvements	<ul style="list-style-type: none"> • Enhances potential for new private development by providing and improving public infrastructure • Provides neighborhood amenities • Alleviates crime/lack of public safety
Redevelopment Plan Amendment	Amend Redevelopment Plan for financial purposes	<ul style="list-style-type: none"> • Utilizes unproductive land • Increases potential for: <ul style="list-style-type: none"> ○ affordable housing ○ homeownership opportunities ○ commercial and retail needs ○ employment opportunities • Alleviates crime/lack of public safety • Creates neighborhood stability • Assists in the prevention of business out-migration • Alleviates depreciated/stagnant property values
Southeastern San Diego/Skyline Paradise Hills Community Plan Update	Identify additional funding and coordinate with City of San Diego for an update of community plans to incorporate redevelopment goals and objectives	<ul style="list-style-type: none"> • Utilizes unproductive land • Increases potential for: <ul style="list-style-type: none"> ○ affordable housing ○ homeownership opportunities ○ commercial and retail needs ○ employment opportunities • Alleviates crime/lack of public safety • Creates neighborhood stability • Assists in the prevention of business out-migration • Alleviates depreciated/stagnant property values

Strategic Plan	Designed as a tool for SEDC to strategize, prioritize, and plan for future projects	<ul style="list-style-type: none"> Enhances the potential for new private development by setting forth a plan to prioritize funding of new development opportunities
Various Public Improvements	Identify funding and install various public improvements in the Project Area	<ul style="list-style-type: none"> Enhances potential for new private development by providing and improving public infrastructure Provides neighborhood amenities Alleviates crime/lack of public safety

D. Proposed Expenditures

The development projects and programs identified in this Plan are dependent upon attracting qualified property owners and developers and obtaining the funds to finance the projects or programs. The expenditures projected for the next five years are anticipated to include costs for Agency project administration and implementation (i.e., property acquisition, relocation, new development, site preparation, transportation/infrastructure projects or improvements, and the provision of affordable housing) and debt service payments related to the issuance of debt.

Tax increment revenue is expected to represent the major funding source for Agency programs. In FY 2010 the Agency expects to receive approximately \$2.2 million in net tax increment from the Project Area. Net tax increment is the amount available for new programs after tax-sharing payments, and County administrative fees. The Agency expects this figure to rise approximately 2% annually over the next five years. Based on this assumption, the Agency can expect to receive approximately \$11.4 million in net tax increment over the next five years.

Tax increment growth over the five years of this Plan, which is based on recently updated financial projections is estimated as follows for the five years of this Plan:

Fiscal Year	Gross Increment	Tax	Taxing Agency Payments	Net Tax Increment
2010	\$2,406,000		\$210,000	\$2,196,000
2011	\$2,461,000		\$221,000	\$2,240,000
2012	\$2,516,000		\$232,000	\$2,284,000
2013	\$2,572,000		\$243,000	\$2,329,000
2014	\$2,648,000		\$258,000	\$2,390,000

Twenty percent (20%) of annual tax increment revenue is required to be set-aside in the Low and Moderate Income Housing Fund for the development of housing affordable to very low, low, and moderate income households. Over the next five years, the Agency anticipates having approximately \$2.5 million available in the housing fund.

Fiscal Year	Gross Tax Increment	Taxing Sharing Payments	Net Tax Increment	
			Non-Housing Funds	Housing Funds
2010	\$2,406,000	\$210,000	\$1,712,000	\$484,000
2011	\$2,461,000	\$221,000	\$1,744,000	\$495,000
2012	\$2,516,000	\$232,000	\$1,778,000	\$507,000
2013	\$2,572,000	\$243,000	\$1,811,000	\$518,000
2014	\$2,648,000	\$258,000	\$1,857,000	\$533,000

SEDC adopted SB 211, which requires redevelopment agencies to comply with Section 33607.7 of the of the Health and Safety Code and compels agencies to initiate tax sharing pass-through payments to taxing entities that did not enter into tax sharing agreements at the time of project area adoption. SB 211 was a simplified procedure for extending debt time limit without requiring an amendment to existing redevelopment plans. Specifically, the pass-through percentages are 20 percent of growth in net tax increment over the debt limit base year value, 16.8 percent of growth in net tax increment over a new base year established in year 10, and 11.2 percent of the growth in tax increment over a third base year established in year 30.

V. EXPLANATION OF HOW THE GOALS AND OBJECTIVES, PROJECTS AND EXPENDITURES WILL ELIMINATE PROJECT BLIGHTING CONDITIONS

Agency-sponsored private developments in the Project Area can be expected to contribute to blight alleviation by reducing conditions such as the following:

- crime
- infrastructure deficiencies
- lack of adequate shopping facilities
- business out-migration
- unemployment
- lack of affordable housing
- residential overcrowding,
- depreciated/stagnated property values
- parcels of irregular/size/shape/topography, and
- vacant/underutilized lots

VI. EXPLANATION OF HOW THE GOALS AND OBJECTIVES, PROJECTS AND EXPENDITURES WILL IMPLEMENT PROJECT HOUSING REQUIREMENTS AGENCY/CITY WIDE(HOUSING COMPLIANCE PLAN)

California's Community Redevelopment Law requires that not less than twenty percent (20%) of all tax increment generated by the Project Area shall be used for the purpose of increasing the community's supply of very low, low and moderate income housing. Additionally, affordable dwelling units must remain affordable for not less than the period of land use controls established in the project plan (currently 45 years for for-sale units and 55 years for for-rent units). The on-going goal for the Project Area is to develop housing in compliance with current legislation and available Project Area resources.

A. Comprehensive Affordable Housing Strategy

The Redevelopment Agency, comprised of the City's Redevelopment Division, Centre City Development Corporation (CCDC) and Southeastern Economic Development Corporation (SEDC), and the San Diego Housing Commission formed the Affordable Housing Collaborative (Collaborative) to accelerate and encourage new affordable housing development citywide. This collaborative is referred to as the Affordable Housing Collaborative. In January 2003, leveraging Redevelopment set-aside funds, the Affordable Housing Collaborative issued a Notice of Funding Availability (NOFA) announcing the availability of \$55 million of secured assets to provide gap financing for very low, low, and moderate income housing. The Agency has committed the entirety of this \$55 million to eleven projects in various project areas, resulting in 722 affordable units and 1,055 affordable bedrooms.

Although the initial funding of the NOFA has been exhausted, affordable housing development proposals requesting local subsidies in the City of San Diego continue to be submitted through different channels to the Redevelopment Agency and/or San Diego Housing Commission. The Collaborative continues to meet to review projects seeking funding under the Affordable Housing Opportunity Fund and to ensure affordable housing goals are being met by the Agency and the Housing Commission.

In June 2006, the Redevelopment Division obtained four bank lines of credit in an aggregate amount of \$34 million which was dedicated to an affordable housing "Opportunity Fund" to continue to assist with the creation and rehabilitation of affordable housing for low- and moderate-income households and to leverage other affordable housing financial sources. Proposed projects in the Project Area may request funding assistance from the Opportunity Fund.

To provide consistency among the three branches of the Redevelopment Agency (Redevelopment Division, CCDC and SEDC) and streamline the negotiation and approval

process for affordable housing projects funded by the Agency, the Affordable Housing Collaborative developed the “Expenditure of Low and Moderate Income Housing Fund Policy and Transaction Guidelines” to be utilized in reviewing affordable housing development proposals. These Policy and Transaction Guidelines were approved by the Agency Board on May 20, 2008 via resolution R-04282 and are reviewed on a periodic basis to reflect changing policies and economic conditions.

B. Housing Assistance Programs

The Agency has implemented a number of special assistance programs to achieve its goals for maintaining affordability and rehabilitating housing in the Project Area. SEDC has primarily focused on owner-occupied housing assistance. SEDC's current programs work through increasing opportunities for affordable financing for acquisition and/or rehabilitation of existing single-family homes. To increase the supply of affordable housing, SEDC's programs include development financing assistance, such as land, acquisition/construction loans and gap financing for new developments. For first-time homebuyers, SEDC offers shared equity loans (silent seconds) and down payment and/or closing cost assistance for low to moderate income families.

SEDC is currently in the process of revising guidelines for the Residential Rehabilitation Program, renamed the Housing Enhancement Loan Program (HELP). The revisions will allow for the expansion of the HELP program to the entire SEDC Area of Influence and will increase loan amounts to \$35,000 with an additional \$10,000 for water and energy conserving improvements.

In addition, SEDC has facilitated homebuyer workshops, where potential purchasers are provided with information on the homebuying process as well as the various home loan programs available in the marketplace. Purchasers receive a credit report, are pre-qualified for a home loan, and where necessary, are assisted with budgeting for a down payment.

In 1999, SEDC adopted an update to its 1993 Housing Policies and Program document. Development guidance was one of the major issues addressed in the updated document.

In 2000, SEDC adopted the Multi-Family Development Guidelines which are utilized to evaluate multi-family development proposals. The Guidelines, which are currently being updated by SEDC, address the site planning, architectural, and landscaping components of development that have an impact on the physical and social fabric of the community.

C. Projects & Expenditures to be made during the Next Five Years

The Project Area's Low and Moderate Income Housing Fund (Housing Fund) has approximately \$869,000 as of the beginning of FY 2009. Projections of annual Housing Funds anticipated to be generated by the Project Area over the next five years are shown in the following table:

Fiscal Year	Low/Mod Fund
2009-10	\$484,000
2010-11	\$495,000
2011-12	\$507,000
2012-13	\$518,000
2013-14	\$533,000
TOTAL	\$2,537,000

It is anticipated that the Project Area's Housing Fund will increase by approximately \$2.5 million during the next five years. All units developed with Agency assistance from the Housing Fund will be restricted to very low, low, or moderate income households. These funds will be used to generate housing within the Project Area as opportunities for housing assistance are identified.

1. Projected Housing Units to be developed in the Next Five Years

California Community Redevelopment Law requires that the Agency prepare an estimate of the number of new, rehabilitated and price-restricted dwelling units to be developed in the Project Area. These numbers also includes the inclusionary housing requirements: units for very low, low, and moderate income households. The inclusionary housing requirements state that fifteen percent (15%) of all new or rehabilitated dwelling units developed by public or private activities, other than the Agency, in a redevelopment project area shall be affordable to low and moderate income households. Forty percent (40%) of the 15% inclusionary housing units shall be at affordability levels for very low income households.

Approximately 15 to 50 dwelling units could be developed using the Project Area's Housing Fund (assuming a per unit subsidy of \$50,000 to \$150,000/unit). The actual amount of Housing Funds will depend upon tax increment receipts. The number of units developed will depend upon the cost of the units, availability of pertinent feasible opportunities for collaboration with housing developers, availability of tax increment-backed debt financing and the ability of the Agency to leverage funds. The Housing Fund expenditures will include costs for housing development, administration, and debt service payments. The Agency anticipates issuing tax allocation bonds or other financial instruments to fund affordable housing projects.

It should also be noted that the City of San Diego Municipal Code (Chapter 14, Article 2, Division 13) places an inclusionary (affordable) housing obligation on new development. While

these new affordable units can not be counted as production under the Redevelopment Agency's definitions, they are, for all intents and purposes, housing units available to low and moderate income households.

The following table indicates the estimated number of units that will be assisted and the estimated expenditures from the Housing Fund in each of the next five years. In addition to the new units noted below, the Strategic Plan and proposed Community Plan Update will assist in identifying development opportunities, address current challenges, and prioritize potential financial investments by the Agency.

Fiscal Year	New Units	Rehabilitated Units	Housing Fund Expenditures *
2010	6	0	\$484,000
2011	0	0	\$495,000
2012	0	0	\$507,000
2013	100	0	\$518,000
2014	10	0	\$533,000
Total	26	0	\$2,537,000
<p>* Housing fund expenditures to be determined based on Strategic Plan and Community Plan Update efforts by the Agency. Estimated amounts when determined, will be addressed in the Implementation Plan's Mid-Term Update. The current estimates on housing units are based on development and funding projections that are presently in the conceptual stage and subject to change in the future as further details emerge.</p>			

The following table indicates the estimated number of Agency assisted and non-Agency assisted units that will be developed in each of the next five years:

Projects	FY2010	FY2011	FY2012	FY2013	FY2014
Non-Agency Assisted	0	0	0	0	13
Proposed Agency Assisted	6	0	0	10	10
Total	6	0	0	10	23

The following table indicates the estimated number of units by income level that will be developed in each of the next five years:

Housing Category	FY2010	FY2011	FY2012	FY2013	FY2014
Market Rate	0	0	0	0	13
Low to Moderate Income	6	0	0	0	3
Very Low Income	0	0	0	10	7
Total	6	6	0	10	23

2. Agency-Developed Units

As required by Section 33490 of the California Community Redevelopment Law, the Implementation Plan must contain an estimate of the number of Agency-developed residential units, if any, which will be developed during the next five years which will be governed by Section 33413(b)(1) and the number, if any, of Agency developed units for very low, low, and moderate income households which will be developed by the Agency during the next five years to meet the requirements of Section 33413(b)(1). Section 33413(b)(1) states that for units developed by the Agency, thirty percent (30%) of all new and rehabilitated dwelling units shall be affordable for low and moderate income households, and not less than fifty percent (50%) of the 30% affordable units shall be affordable to very low income households. The Agency does not anticipate developing any residential units during the next five years.

D. Housing Unit Estimates for the Next Ten Years and the Life of the Plan

It is estimated that up to 39 new, substantially rehabilitated, or price-restricted residential units will be developed in the Project Area during Fiscal Years 2010 through 2019. The following table illustrates the anticipated breakdown of total new dwelling units developed for very low, low, and moderate income households over the next ten years as required by Section 33413(b)(2) of the California Community Redevelopment Law.

Fiscal Year	Total Units	Low & Moderate Income (15%)	Very Low Income (40% of 15%)
2010	6	6	0
2011	0	0	0
2012	0	0	0
2013	10	0	10
2014	10	3	7
2015	0	0	0
2016	0	0	0
2017	0	0	0
2018	0	0	0
2019	13	0	0
TOTAL	39	9	17

The estimated number of dwelling units that could be developed in the Project Area over the life of the Redevelopment Plan (2027) is 259 units including an estimated 39 new units. No substantially rehabilitated units are estimated at this time. The actual number of units developed will depend on market conditions and be determined as specific projects area pursued.

E. Very Low, Low, and Moderate Income Units Developed in the Project Area

Table A, Details of Housing Production, provides a summary of the Project Area's housing production including the number of units that were produced and the amount of Housing Funds used to assist the production of very low, low, and moderate income units the for Project Area for the period of the previous implementation plan (2004-2009).

TABLE A

DETAILS OF HOUSING PRODUCTION
SOUTHCREST REDEVELOPMENT PROJECT AREA
City of San Diego - Redevelopment Agency

TOTAL HOUSING PRODUCTION	AFFORDABLE HOUSING (for Low & Moderate Income)												
	Required			Produced / To Be Produced ¹			Less Replacement Units ³			Net Surplus/Deficit			
	Very Low	Low & Mod	TOTAL	Very Low	Low & Mod	TOTAL	Very Low	Low & Mod	TOTAL	Very Low	Low & Mod	TOTAL	
I. INCEPTION OF PROJECT AREA TO PRESENT (FY 1994 - 2003)													
Agency Assisted													
Southcrest Park Estates I	5	-	1	1	-	10	10	-	-	-	0	9	9
Boston Village	12	1	1	2	-	12	12	-	-	-	(1)	11	10
38th Street Homes	4	-	1	1	-	4	4	-	-	-	-	3	3
Non-Agency Assisted													
Southcrest Park Estates I	28	2	2	4							(2)	(2)	(4)
Outside Project Area													
	-	-	-	-	-	-	-	-	-	-	-	-	-
SUBTOTAL ¹	49	3	5	8	-	26	26	-	-	-	(3)	21	18
II. PREVIOUS PLAN PERIOD (FY 2004 - 2009)													
Agency Assisted ¹													
Southcrest Park Estates II	10	1	1	2	-	10	10	-	-	-	(1)	9	8
Non-Agency Assisted													
Boston Village - New	9	-	1	1							-	(1)	(1)
Legacy Walk	110	7	10	17							(7)	(10)	(17)
Southcrest Park Estate II	52	3	5	8							(3)	(5)	(8)
Outside Project Area													
	-	-	-	-	-	-	-	-	-	-	-	-	-
SUBTOTAL ¹	171	8	12	20	0	10	10	-	-	-	(8)	(2)	(10)
III. CURRENT 10-YEAR FORECAST (FY 2010-2019)													
Agency-Assisted (Estimates)													
40th & Alpha	6	-	1	1	2	4	6	-	-	-	2	3	5
Various Multi-family Development	20	1	2	3	17	3	20	-	-	-	16	1	17
Non-Agency Assisted (Estimates)													
Various Multi-family Development	13	1	1	2							(1)	(1)	(2)
Outside Project Area (Estimates)													
	-	-	-	-	-	-	-	-	-	-	-	-	-
SUBTOTAL ¹	39	2	4	6	19	7	26	-	-	-	17	3	20
IV. DURATION OF PROJECT AREA (1994-2027) COMPARED TO CURRENT PRODUCTION COUNT													
CUMULATIVE TOTAL ²	259	13	21	34	19	43	62	0	0	0	6	22	28

The current estimates on housing units are based on development and funding projections that are presently in the conceptual stage and subject to change in the future as further details emerge. Estimated amounts when determined will be addressed in the Implementation Plan's Mid-Term Update.

¹ Required housing production for individual line items has been rounded to the nearest whole integer.

² The "cumulative total" is not the sum of the subtotals, but rather 15% and 40% of the total estimated units produced during the life span of the Project Area. The shaded areas on this line represent progress to-date toward the overall project area.

³ Replacement units do not count toward the inclusionary obligation of the redevelopment agency/redevelopment project area and are not counted for the purpose of reporting progress in meeting the project area's inclusionary production requirements.

The following table provides the number of units that were produced for families with children and the amount of Housing Funds used to assist the production of such units for the period of the previous implementation plan (2004-2009).

Project	Housing Type	Total Units	Affordable Units	Income Level	Housing Funds
Southcrest Park Estates II	Family	62	10	Moderate	\$151,448
Mayberry Townhomes Rehabilitation*	Family Rental	70	69	Very low and low	\$1,381,000
Legacy Walk	Family	110	11	Moderate	\$0

* Mayberry Townhomes Rehabilitation is not considered a substantial rehabilitation according to California Redevelopment Law and therefore is not counted in the total production or rehabilitation of units.

F. Replacement of Dwelling Units Destroyed or Removed

The Redevelopment activities outlined in this Plan do not remove or destroy any housing units currently restricted to low or moderate income families. Where Redevelopment activities are planned, the Redevelopment will destroy a small number of market-rate rental units and replace these units with a much greater number of market-rate and very low, low, and moderate income units. Therefore, it is expected that units removed or destroyed will be replaced to a much greater extent than required by California Community Redevelopment Law. (See Table A)

G. Compliance with Housing Element and Regional Housing Share Requirements

The City of San Diego's regional share of housing need for persons of very low, low, and moderate income is published in the Housing Element of the City's General Plan. According to the City's FY 2005-2010 Housing Element, the proportional share of housing need in San Diego is 23% very low income (10,645 units city-wide), 18% low income (8,090 units city-wide), 19% moderate income (8,645 units city-wide) and 40% above moderate income (18,362 units city-wide).

Section 33334.4(a) of the California Community Redevelopment Law requires that the Agency expend Low and Moderate Income Housing funds to assist in the development of housing for persons of very low, low, and moderate income in at least the same proportion as the total number of housing units needed for each of those income groups within the community as each of those needs have been identified in the most recent determination pursuant to Government Code Section 65584 (i.e., the regional share of the statewide housing need). Using this definition and a denominator based upon the need for affordable units (total of 27,380 units), the threshold for the expenditure of low- and moderate income housing funds is as follows: 39% very-low income (10,645 units), 29% low income (8,090 units), and 32% moderate income (8,645 units).

In addition, Section 33334.4(b) of the California Community Redevelopment Law states, “Each agency shall expend, over the duration of each redevelopment implementation plan, the monies in the Low and Moderate Income Housing Fund to assist housing that is available to all persons regardless of age in at least the same proportion as the number of low-income households with a member under the age of 65 years bears to the total number of low-income households of the community as reported in the most recent census of the United States Census Bureau.”

According to the 2000 census, there are 450,691 households in the City of San Diego. Of those households, 81,124 are “Senior Head of Household”. Of those, “Senior Head of Household”, 39,751 (49%) are low and moderate income. The total number of low and moderate income households in San Diego is 181,572. Therefore, the ratio of low and moderate income senior households to the total number of low and moderate income households is 21.89% (39,751/181,572).

The Agency will expend Housing Funds in the proportions cited above to ensure compliance with Redevelopment Law. The following table provides the proposed percentages of housing funds the Agency anticipates spending from the Project Area Housing Fund for housing to match the City’s proportional share of housing need. The minimum percentages are the least amount the Agency may spend, and the maximum percentages are the most the Agency may spend for the categories of income and age. These proportionality tests must be met between January 1, 2002 and December 31, 2014, and then again every 10 years through the termination of the Project Area.

Household Type	No. Of Households	Percentage of Housing Funds to be Expended	
Income			
Very Low Income	10,645	at least	39%
Low Income	8,090	at least	29%
Moderate Income	8,645	no more than	32%
TOTAL	27,380		
Age			
LM Households Under Age 65	181,572		78%
LM Household Over Age 65	39,751	no more than	22%

Table B, Housing Expenditures and Proportionality, documents the amount of Housing Fund revenues expended and anticipated to be expended Based upon the expenditures to date, the Agency will need to target more of its Housing Funds toward very low and low income units in order to meet the legal requirements for expenditures in proportion to the community’s housing needs by income category for the compliance period.

The Agency has also expended Housing Funds toward the Residential Rehabilitation Program since 2004 as follows:

Home Repair Grants	July 2004 – March 2009	\$95,000
Exterior Enhancement Grants	July 2004 – March 2009	\$55,000
Total		\$150,000

Future expenditures have not yet been determined, pending the Agency's Strategic Plan and Community Plan Update efforts. As such, the Agency will work toward ensuring that future expenditures will meet the legal requirements for expenditures in proportion to the community's housing need by income category and household type for the compliance period.

TABLE B

HOUSING EXPENDITURES AND PROPORTIONALITY*
 SOUTHCREST REDEVELOPMENT PROJECT AREA
 City of San Diego Redevelopment Agency

	\$ by Household Type		Income Category (# of units)			
	No Age Restriction	Seniors	Very Low	Low	Moderate	Total Restricted
FY 02	\$ -	\$ -	-	-	-	-
FY 03	\$ -	\$ -	-	-	-	-
FY 04	\$ -	\$ -	-	-	-	-
FY 05	\$ 151,448	\$ -	-	-	10	10
FY 06	\$ 267,580	\$ -	-	-	9	9
FY 07	\$ -	\$ -	-	-	-	-
FY 08		\$ -	-	-	-	-
FY 09		\$ -	-	-	-	-
FY 10	\$ 484,000	\$ -	2	2	2	6
FY 11	\$ 495,000	\$ -	-	-	-	-
FY 12	\$ 507,000	\$ -	-	-	-	-
FY 13	\$ 518,000	\$ -	7	-	-	7
FY 14	\$ 533,000	\$ -	10	0	3	13
Subtotal - Compliance Period (FY 02 - FY 14)						
Units	45	0	19	2	24	45
\$	\$ 2,537,000	\$ 0%	\$ 1,071,178	\$ 112,756	\$ 1,353,067	\$ 2,537,000
% of \$ (TO-DATE)	100%	0%	42%	4%	53%	
% of Units (TO-DATE)	100%	0%	42%	4%	53%	
% (TARGET)	78%	22%	39%	29%	32%	
Since Inception (FY 94 - FY 01)						
Units	21	0	0	0	21	21
\$	\$ 2,491,000	\$ -	\$ -	\$ -	\$ 2,491,000	
Project Area Total (FY 94 - FY 14)						
Units	66	0	19	2	45	66
\$	\$ 2,537,000	\$ -	\$ 1,071,178	\$ 112,756	\$ 3,844,067	\$ 5,028,000
% of \$ (TO-DATE)	\$ 1	\$ -	21%	2%	76%	
% of Units (TO-DATE)	100%	0%	29%	3%	68%	
% (TARGET)	78%	22%	39%	29%	32%	
Redevelopment Agency Total (To-Date)						
Units	3,098	1,130	2,925	616	687	4,228
\$	\$ 104,200,564	\$ 25,039,043	\$ 89,410,088	\$ 18,829,612	\$ 20,999,908	\$ 129,239,607
% of \$ (TO-DATE)	81%	19%	69%	15%	16%	
% of Units (TO-DATE)	73%	27%	69%	15%	16%	
% (TARGET)	78%	22%	39%	29%	32%	

*Future Housing Fund expenditures to be determined based on Strategic Plan and Community Plan Update efforts by the Agency. Estimated amounts when determined will be addressed in the Implementation Plan's Mid-Term Update. The current estimates on housing units are based on development and funding projections that are presently in the conceptual stage and subject to change in the future as further details emerge. Page 19